

## Information sheet

# Temporary restrictions on state-controlled roads during wet weather and flooding

November 2018

**Please note: this Information Sheet refers to state-controlled roads only and not Local Government roads.**

The Queensland state-controlled road (SCR) network is made up of around 33,500 km of roads and about 6,500 bridges and major culverts. These are essential for connecting communities, industry and business.

## Road restrictions / closures

Flooding can cause extensive damage to roads, bridges and property. For the safety of all road users, and to protect the road for the future, temporary road closures are necessary while there is water on the road and, in some instances, for some time after the water has receded.

Department of Transport and Main Roads policy states that SCRs are closed when the depth of still water is 300 mm or more. In cases where the water is flowing, roads are closed at a lower depth, depending on the speed of flow – the faster the flow of water, the lower the depth for closure.

More information is available in Engineering Policy EP147 *Road closure policy for wet weather and flooding* located at <https://www.tmr.qld.gov.au/business-industry/Technical-standards-publications/Engineering-policies>.

For detailed up-to-date information on road restrictions and traffic incidents or hazards, visit the QLD *Traffic* website or mobile app, or phone 13 19 40.

The department understands the impact flooding has on communities and industry and seeks everyone's assistance in preserving Queensland's roads during and following wet weather and flooding.

## Heavy and over-mass vehicles

The type of water damage may impact the weight that a road can take and heavy mass vehicles may not be able to use some roads (including over-mass permitted roads) until they are repaired.

The Heavy Vehicle Excess Mass and Dimension hotline 1300 105 647 is available 8.30am–5.00pm Mon to Fri, and provides information on the conditions of operation.

## Signage

For road user safety, the department installs Restricted Road Use Notices (RRUNs). These notices / signs make sure the road closure or restriction is clearly identified.

The restrictions notify the public of the road condition and help protect roads from sustaining further damage.

The RRUNs shown are enforceable under Section 46 of the *Transport Infrastructure Act 1994* and a penalty applies if a person drives past these signs (unless access approval has been granted – see following section).

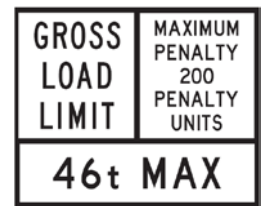

## Approval to drive past a Restricted Road Use Notice

**Single trip access (one-way trip only)** applications are considered where there are extenuating circumstances (delivery of food, water or medical supplies).

**Local area access (multiple trip)** approvals are available for areas where SCRs are restricted for an extended period of time. Approval will apply to people who need to access their residence, property, business or essential services on a restricted SCR.

Both applications will be assessed on a case-by-case basis and, if written approval has been issued, it will be subject to a number of conditions.

### Transport and Main Roads Transport

**Inspectors (single / multiple trips)** approvals are available in special circumstances where it is necessary for ensuring the safety of persons.

Applications to drive past the RRUN can be made through a Transport and Main Roads regional office:

<http://tmr.qld.gov.au/About-us/Contact-us/In-person/Roads-offices>.

Queensland Police Service (QPS) <https://www.police.qld.gov.au/RegionalPolicing/> also has this power but applications should be made first to Transport and Main Roads wherever possible.

The sign following applies where local access approval has been granted for access to a restricted road. Permits are still valid, however, if there is no 'Local Access Permits Excepted' sign present on the multi-message panel.

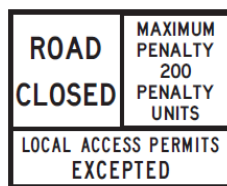

## North Queensland roads

During the wet season, a five tonne load limit applies to vehicles travelling on the Peninsula Developmental Road and Burke Developmental Road. This allows access to residences, properties and businesses, when it is safe to do so, without the need for a RRUN approval.

Application can be made for a Load Limit Permit for higher-mass vehicles under the *Heavy Vehicle National Law Act 2012*, where the movement of essential supplies or other urgent travel is necessary. The permit holder must ensure the route is suitable for the proposed travel and meet costs of excessive damage caused. Contact Far North District on telephone 13 19 40.

## Fire and smoke on state-controlled roads

The bushfire season in Queensland generally occurs between late July and February.



Temporary closure of roads can occur during 'burning off' operations or the fire season, to protect persons, property or the environment from danger or potential danger caused by fire.

Special care is required by motorists when thick smoke is present on roads, to minimise the likelihood of vehicles stopping within the smoke zone and posing a hazard to following vehicles. Motorists should comply with all signage.

More information is available on the websites, [www.qfes.qld.gov.au](http://www.qfes.qld.gov.au), [www.ruralfire.qld.gov.au](http://www.ruralfire.qld.gov.au) and [www.qldtraffic.qld.gov.au](http://www.qldtraffic.qld.gov.au).

Queensland Fire and Emergency Services collaborate with Transport and Main Roads and QPS about restriction of roads during the bushfire season and fire / smoke hazardous situations.

## No Entry signs (all roads)

The signs following may be placed at the site of a road closure. Unlike RRUNs, no approval will be granted for driving past a No Entry sign. The white on black is a Light Emitting Diode (LED) sign.

Three demerit points and a fine will apply to any member of the public who drives past a No Entry sign.



## Contact information

### After hours contact numbers

If contact cannot be made with the regional office, please contact 13 19 40 and hold for a Transport and Main Roads operator.

### Policy and standards

[timanagement@tmr.qld.gov.au](mailto:timanagement@tmr.qld.gov.au)

### Signage

[TrafficEngineering.Support@tmr.qld.gov.au](mailto:TrafficEngineering.Support@tmr.qld.gov.au)